

**DRAINAGE IMPROVEMENTS (LEGEND)**

- PHASE 1
- PHASE 2
- PHASE 3
- AREA TO SEE RELIEF

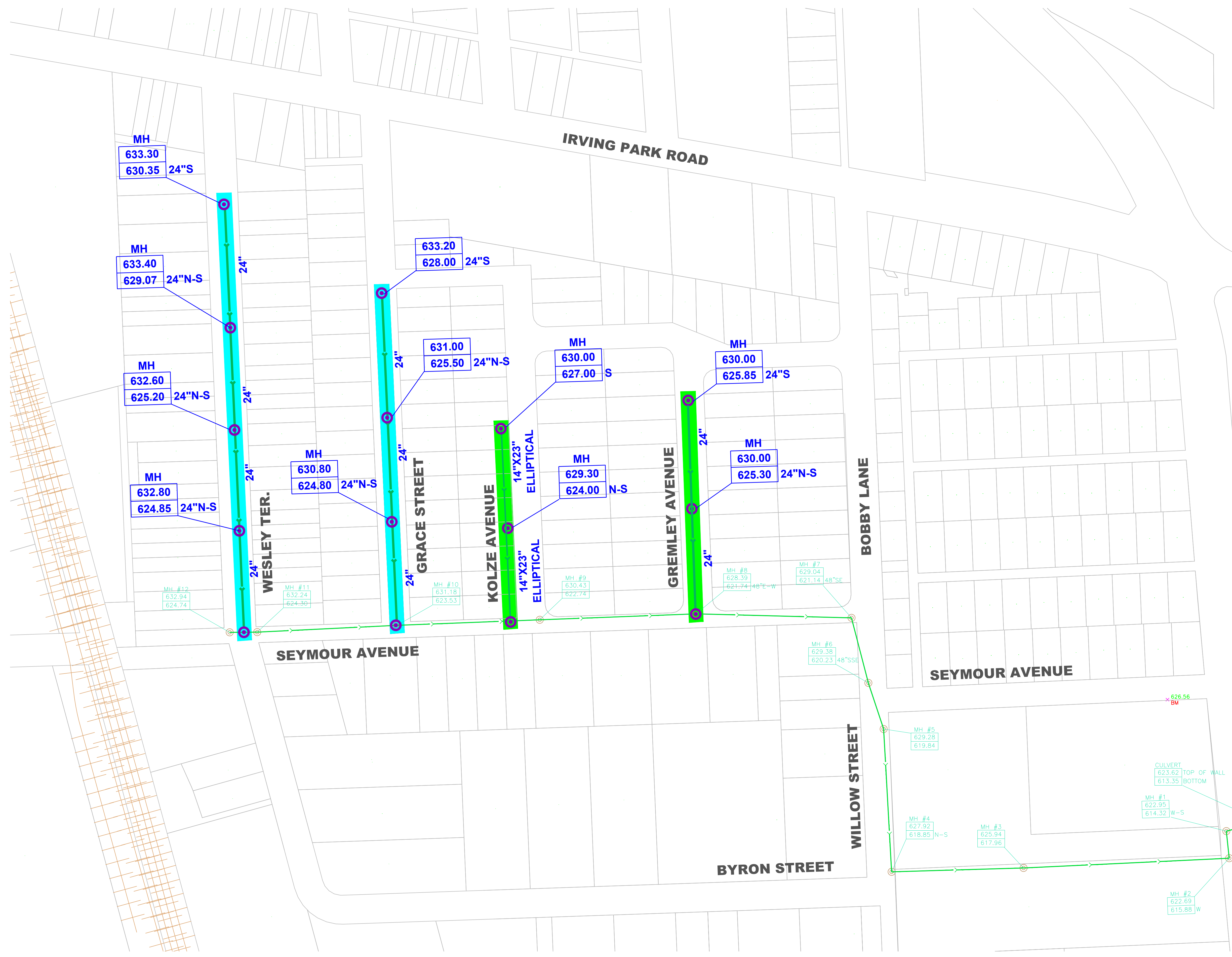

Drawing file: W:\Projects\_by\_Village\Schiller Park\80020177 - Flooding Investigations\Site\Flooding\_Extension\_Exhibit.dwg Feb 22, 2021 1:10pm

**HANCOCK ENGINEERING**

100+ Years of Excellence

- ◆ Civil Engineers
- ◆ Municipal Consultants
- ◆ Established 1911

9933 Roosevelt Road  
Westchester, IL, 60154-2780  
Phone: 708-865-0300  
www.hancock.com

**DRAINAGE IMPROVEMENTS  
SCHILLER PARK, ILLINOIS**

**AREA SOUTH OF IRVING PARK ROAD  
BETWEEN WESLEY TER. AND BOBBY LANE  
PROPOSED STORM SEWER EXTENSIONS**

REVISION:	SCALE: NOT TO SCALE	SHEET
	DRAWN BY: MK	<b>1</b>
	BOOK NO.: -	<b>2</b>
	DATE: 02-22-21	
	E.H.E. NO.: 800-20-17705	

**PHASE 2  
ON REVERSE**